

## FHM Fan Range Details

The Finna High Pressure Medium sized Backward Curve Centrifugal fan range is capable of producing low volumes with high pressures.

### FHM duty range

- x Volumes up to 4,500 m<sup>3</sup>/hr
- x Pressures up to 6,500 Pa
- x Peak efficiency 81%

### FHM fan sizes range from

- x 63 mm - 250 mm as standard.

### Fan casing materials

- x Polypropylene
- x Fire Retardant Polypropylene
- x UPVC/GRP
- x PVDF/GRP
- x PVDF

### Impeller materials

- x Polypropylene

### Steelwork

- x Mild steel / galvanized as standard

### Fixings

- x A2 stainless steel minimum

### Performance data

- x In accordance with BS EN ISO 5801 (BS848-1)
- x Category D test. Ducted inlet, ducted outlet

# FHM 63 - 250 Dimension Details

## Dimensions

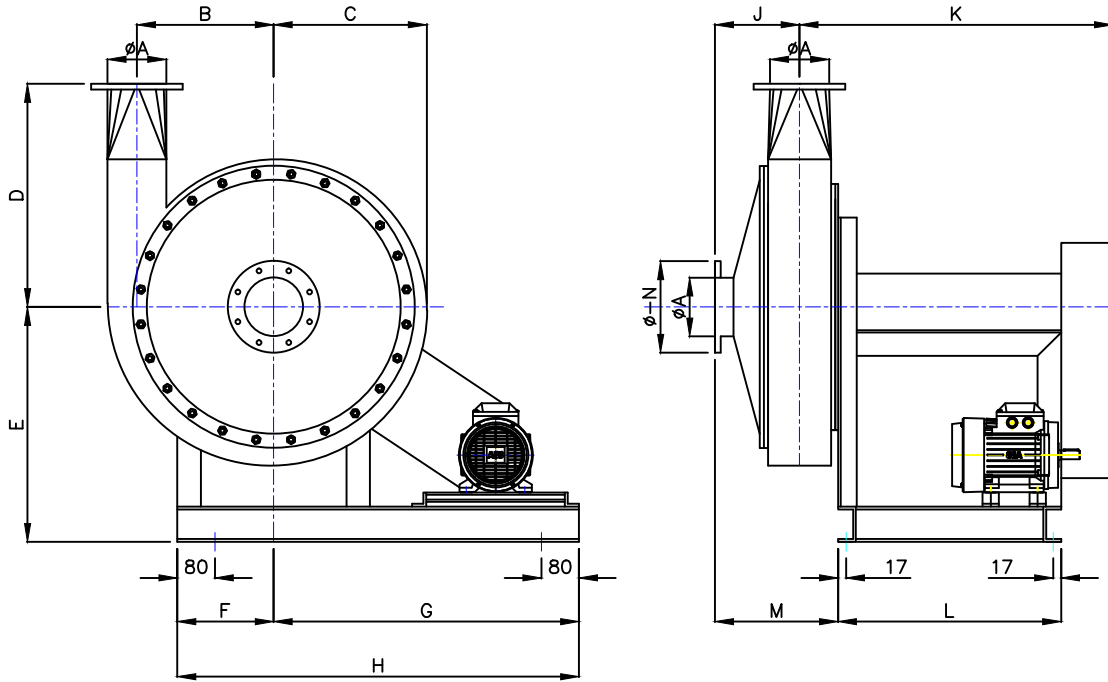

E = All fan handings

Drain threaded socket - 0.75" BSP std

4 off 11mm fixing holes

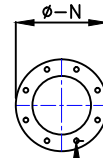

P-no off  $\phi 9$  holes on  
a Q- pcd off crs

## Dimension details

Fan Size	A	B	C	D	E	F	G	H	J	K	L	M	N	P	Q
FHM 63	63	275	306	425	500	205	650	855	180	659	475	254	125	8	101
FHM 90	90	283	316	450	500	205	650	855	180	659	475	257	150	8	126
FHM 125	125	291	325	475	500	205	650	855	180	659	475	262	195	8	165
FHM 160	160	294	333	500	500	205	650	855	180	659	475	270	230	8	200
FHM 200	200	304	337	550	500	205	650	855	200	667	475	290	270	10	240
FHM 250	250	318	361	560	500	205	650	855	200	677	475	293	320	12	290

### FHM 63 Performance Curve

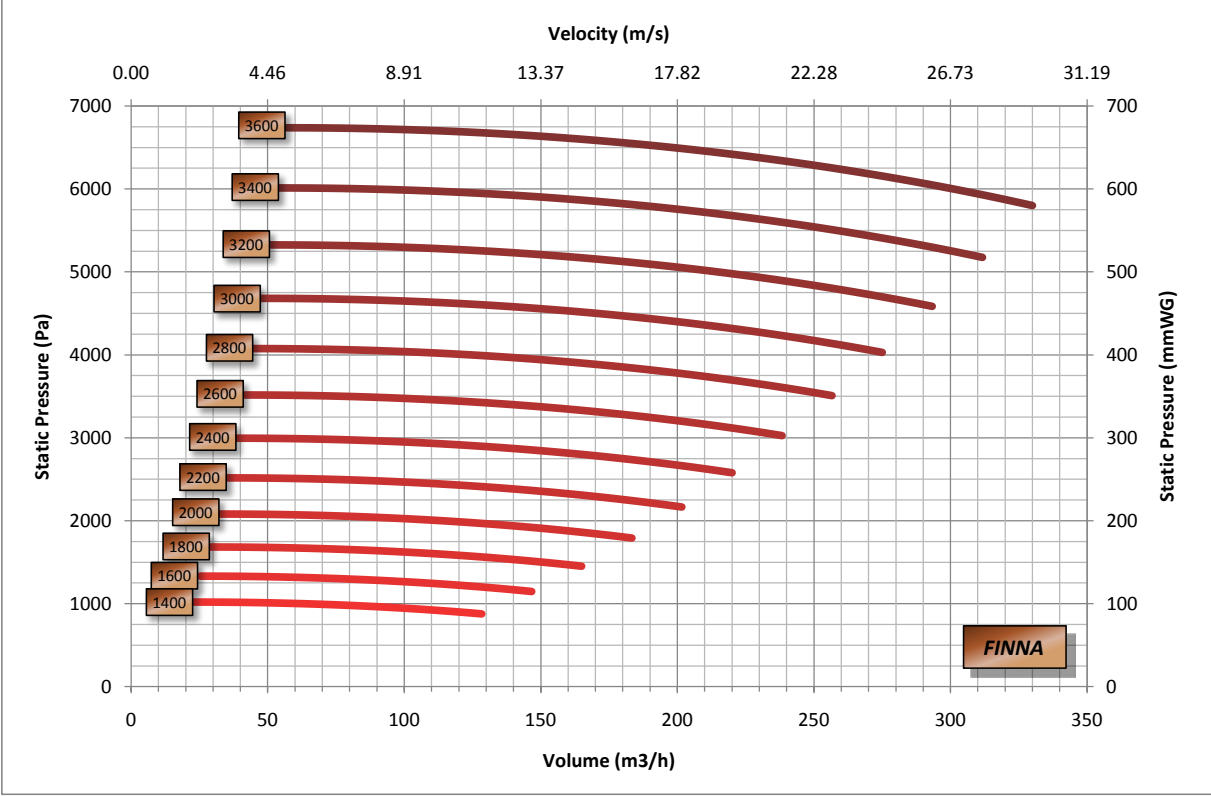

### FHM 63 Power / Efficiency Curve

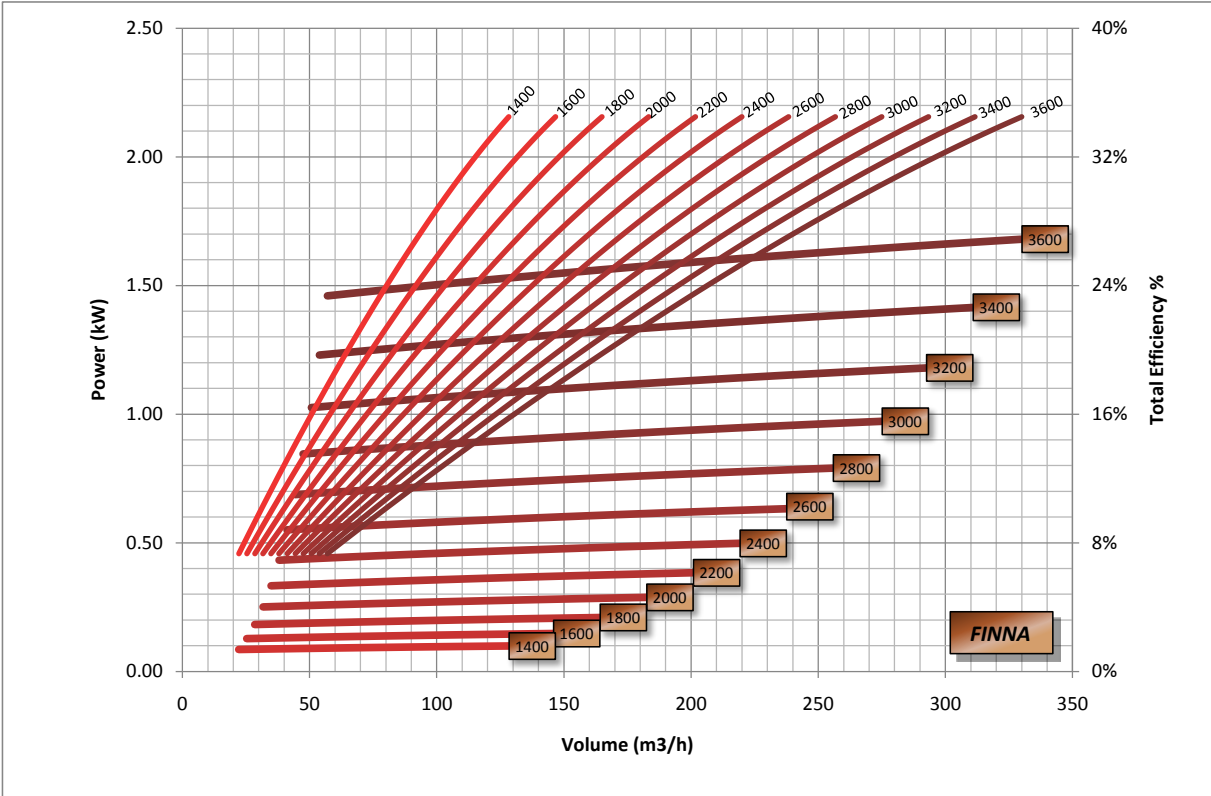

### FHM 90 Performance Curve

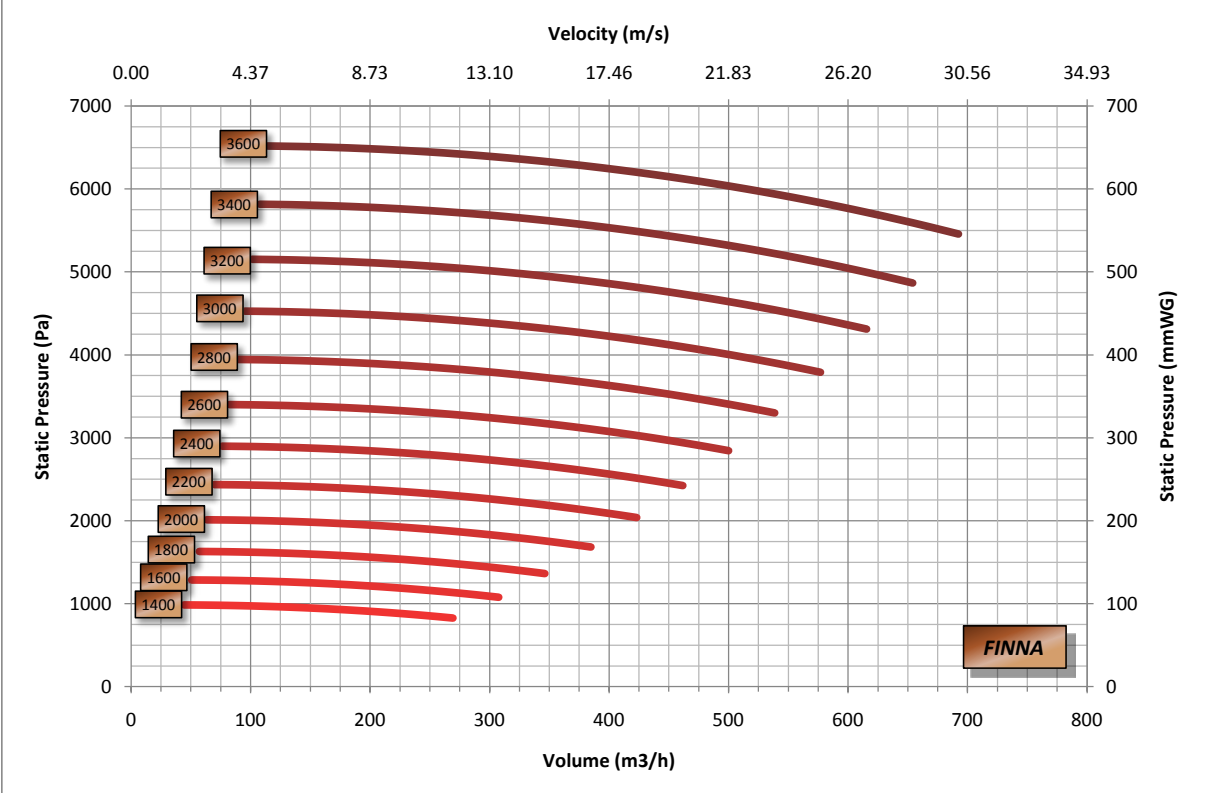

### FHM 90 Power / Efficiency Curve

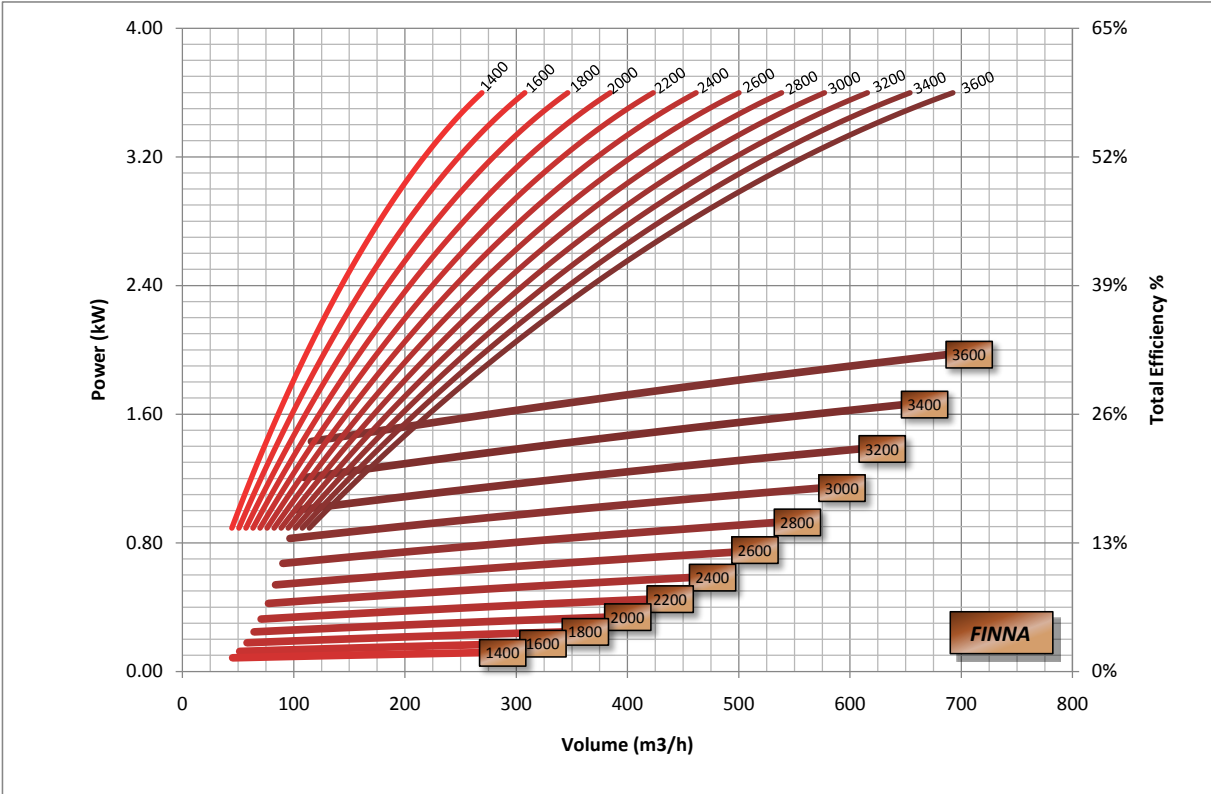

### FHM 125 Performance Curve

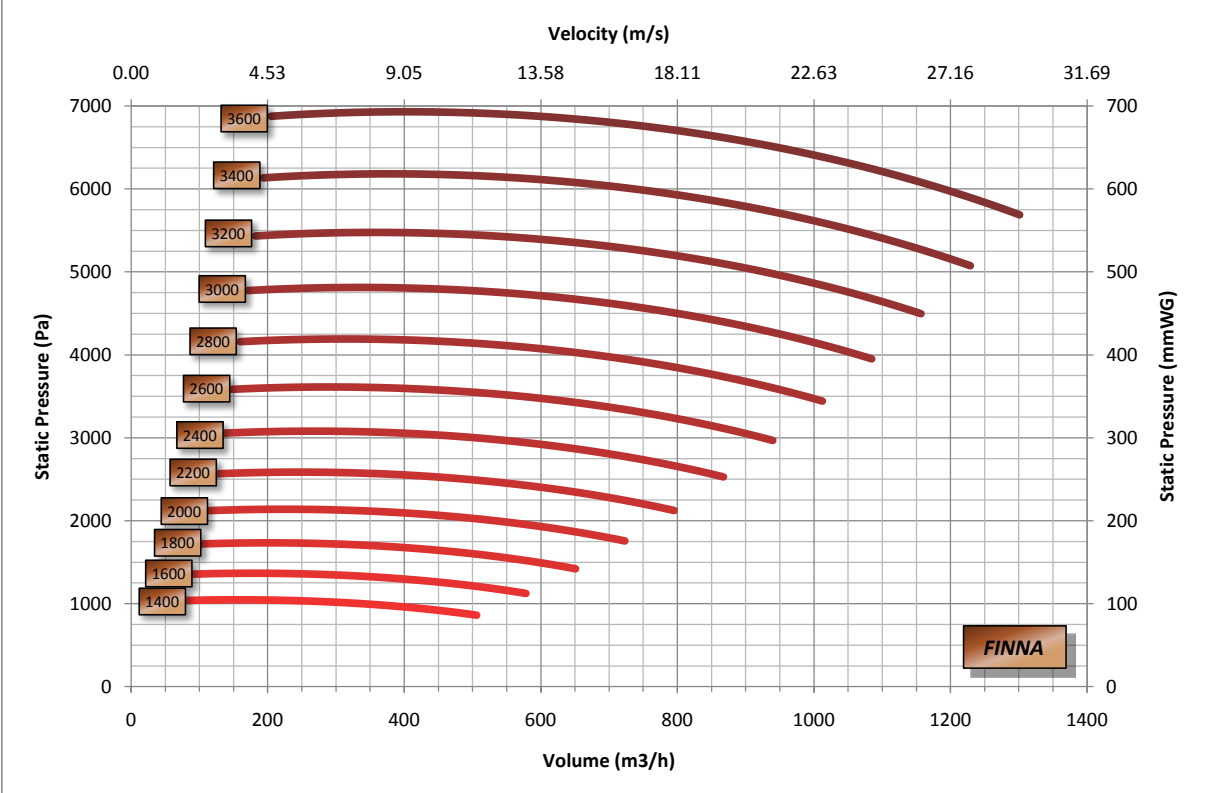

### FHM 125 Power / Efficiency Curve

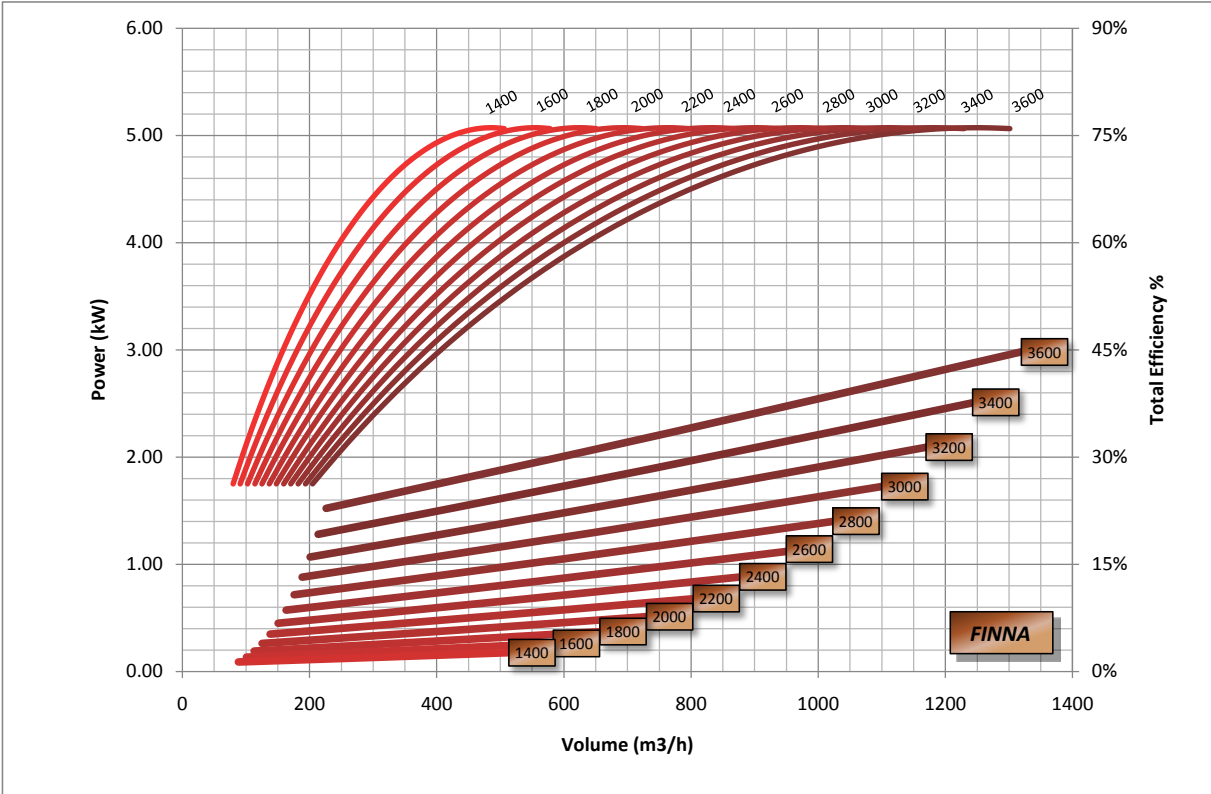

### FHM 160 Performance Curve

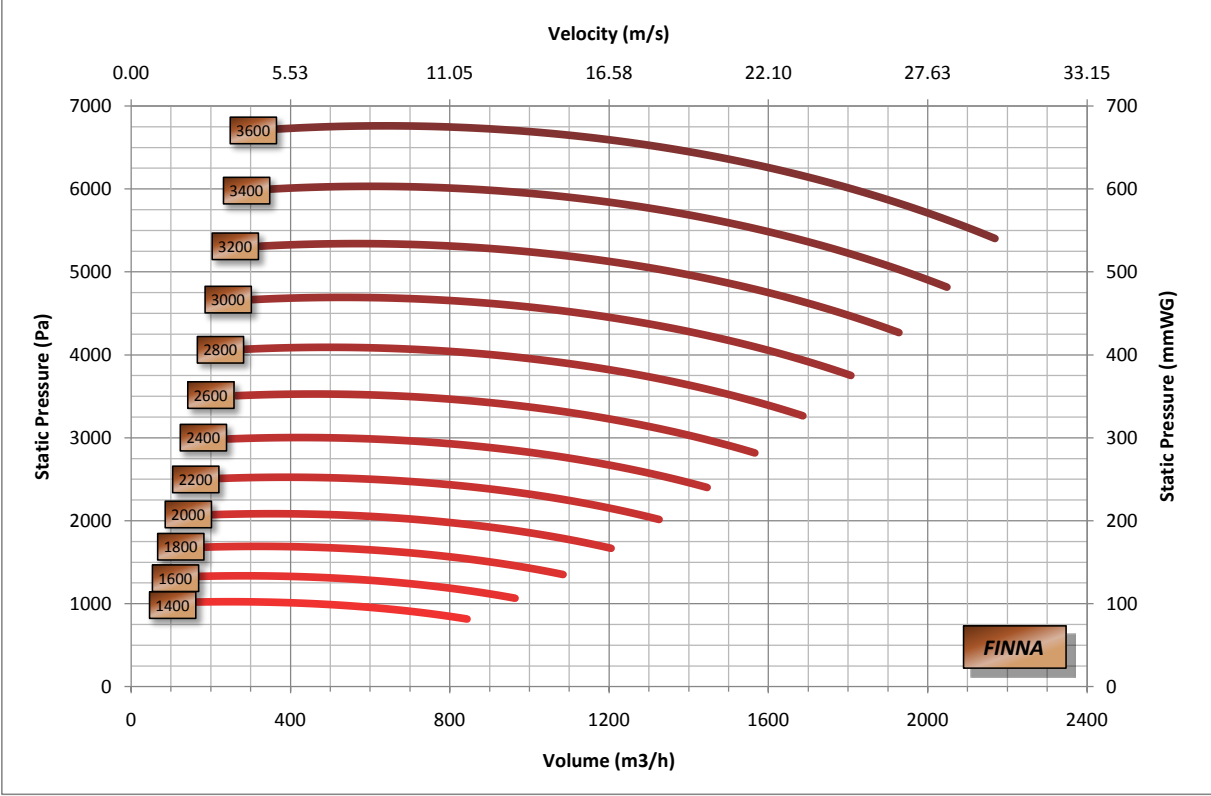

### FHM 160 Power / Efficiency Curve

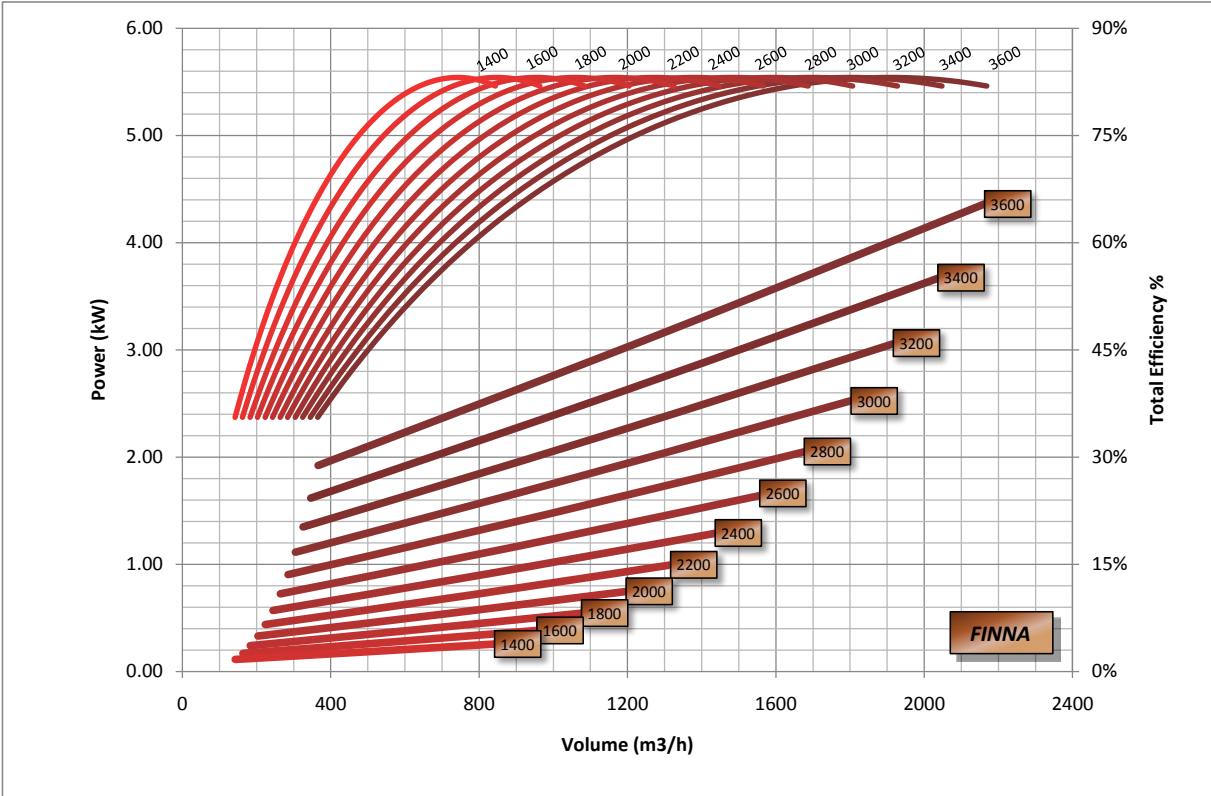

### FHM 200 Performance Curve

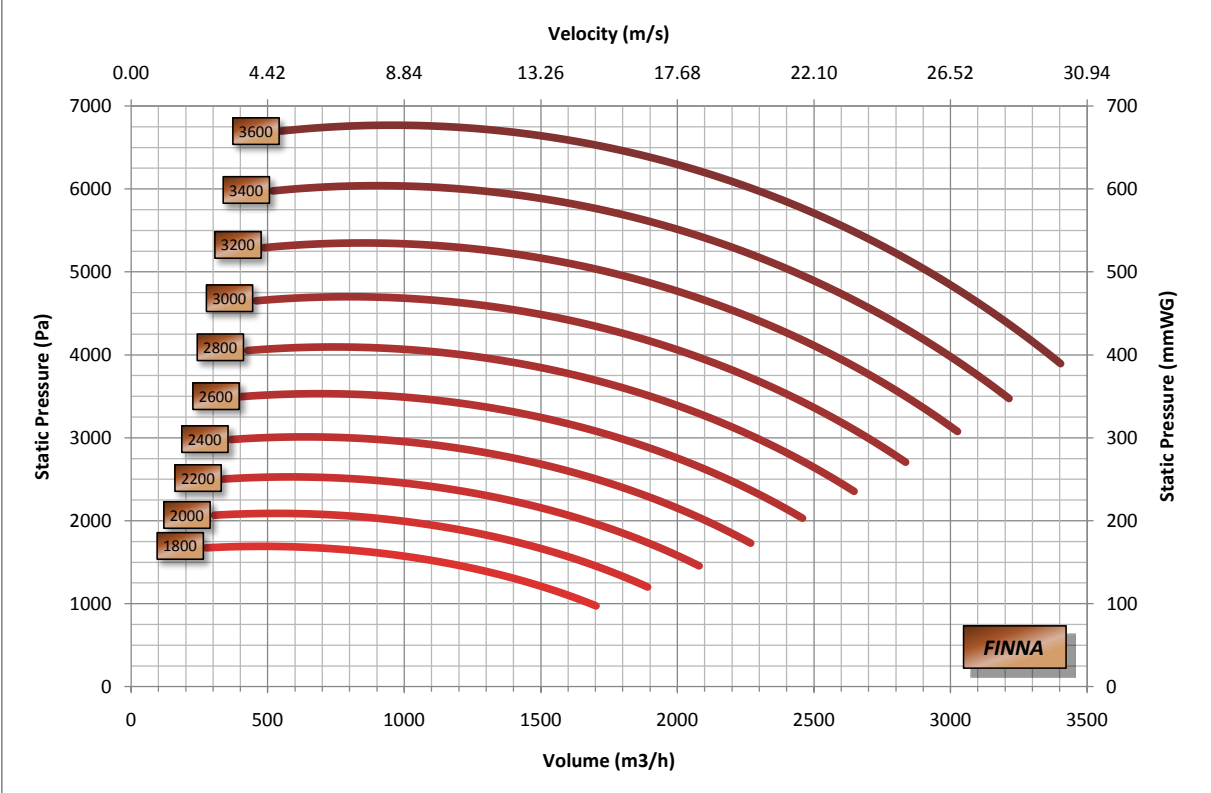

### FHM 200 Power / Efficiency Curve

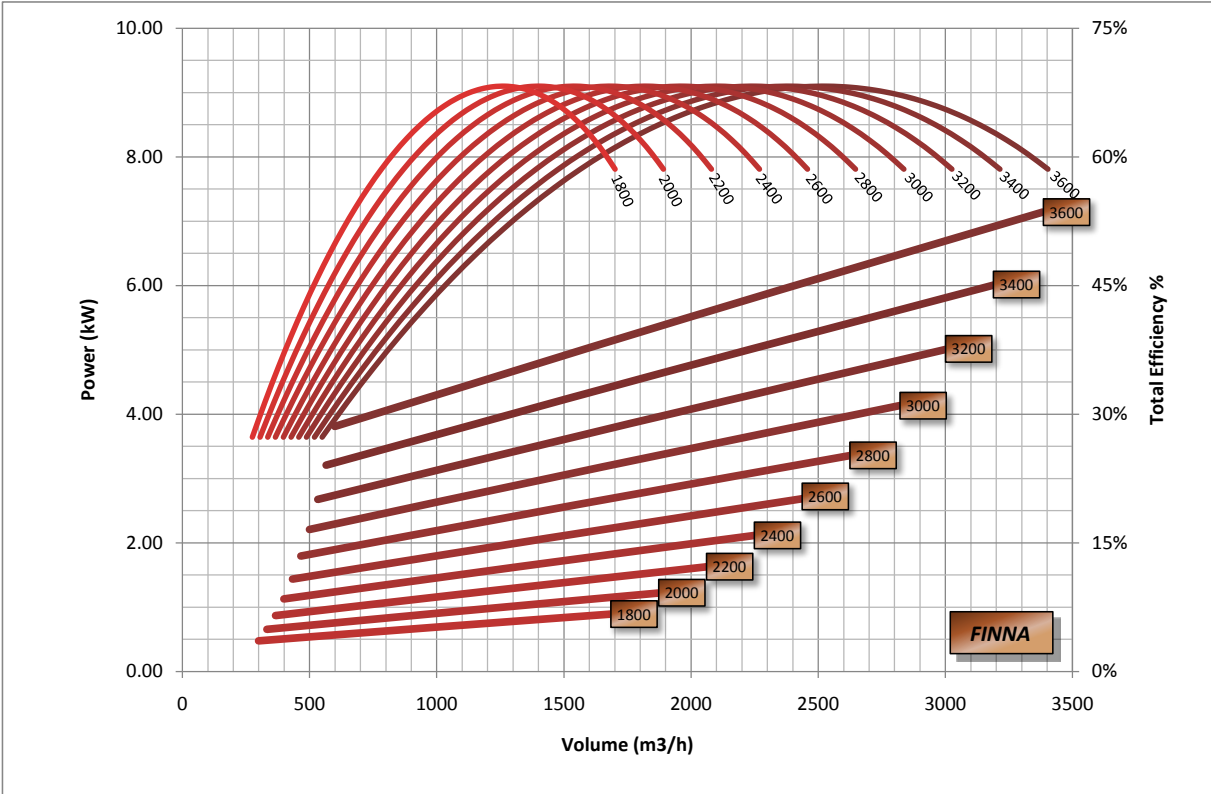

### FHM 250 Performance Curve

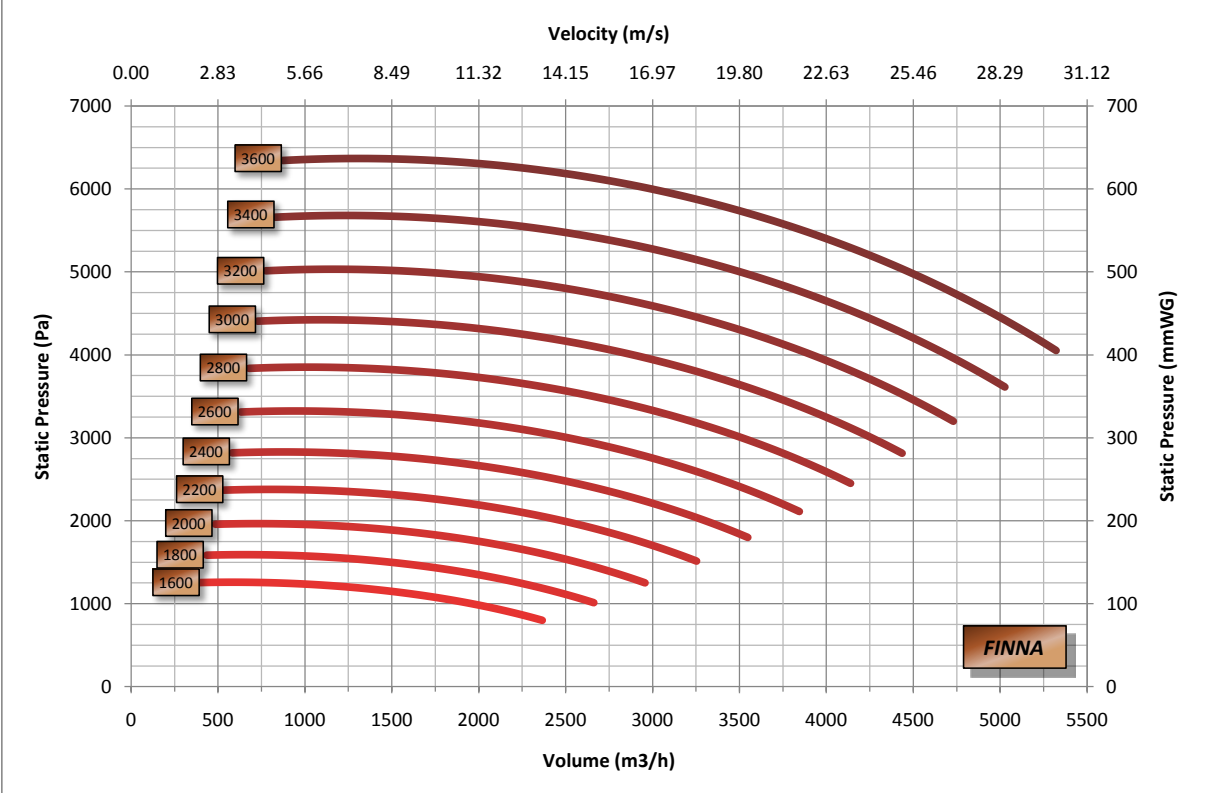

### FHM 250 Power / Efficiency Curve

